

**WORLD
ATHLETICS™**

INTERNATIONAL MEASUREMENT CERTIFICATE

Name of Race

Distance

Location

Country

Date of Race

Date of Measurement

Elevation Change

Separation

% of race distance

Name(s) of the measurer(s)

World Athletics – AIMS Grade

Country

Certificate Number

Expiry Date

International Measurement Administrator

Registered On

Signed

Bernard Conway

In cooperation with

This certificate certifies that the length of the above road race has been established by an accredited World Athletics – AIMS Grade A or B measurer employing the method of a bicycle calibrated with a "Jones Counter". It remains valid for 5 years subject to the course defined in the full measurement report submitted by the measurer being unchanged in any way. Any modifications to the course, however minimal, will nullify this Certificate and require a new measurement to be undertaken. Possession of this certificate does not indicate any sanction of the race by World Athletics or membership of AIMS.





Calgary Half Marathon

WA & AIMS Certified
CAN-2023-062A
 Certification Expires Dec 31/2028

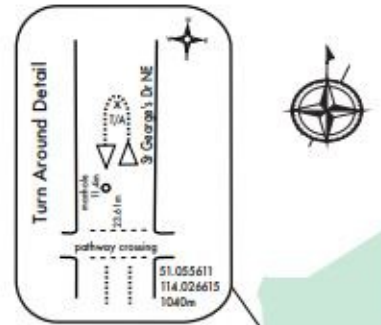

- Stampede Tr - ER
- Olympic Wy - ROC
- 9 Av - ROC
- 12 Street - ER
- Zoo Rd - ROC
- Memorial Dr Acc - ER
- 12 Street - ROC
- St George's Dr - ROC
- turn point
- St George's Dr - ROC
- 12 Street - ROC
- 1 Avenue - ROC
- 4 Street - ROC
- Memorial Dr - LOC
- Centre St Bridge - ER
- Riverfront Av - ROC
- 5 Street - ROC
- Confluence Wy - ROC
- 6 Av - ROC
- 6 Street - ROC
- 9 Av - ROC
- Olympic Wy - ROC
- 11 Av - ROC
- 14 Street - RCL
- Kensington Rd - RCL
- 10A St - ROC
- Memorial Dr - ROC
- Centre St Bridge - ROC
- Riverfront Av - ROC
- 5 Street - ROC
- Confluence Wy - ROC
- 6 Av - ROC
- 6 Street - RCL
- 9 Av - ROC
- Olympic Wy - ROC
- 12 Av - ER
- 7 St - ER
- MacDonald Br - ER
- MacDonald Av - ER
- Enmax Park Rd - ER
- ER - Entire Road
- ROC - Right of Centre
- RCL - Right Curb Lane
- LOC - Left of Centre
- LCL - Left Curb Lane

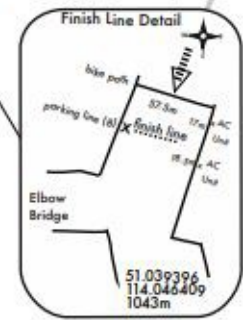
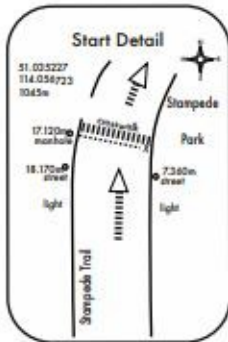

All split locations (each km & turn point) are GPS referenced.

From start line on Stampede Trail to the finish line at the Enmax Park all corners are to be coned and marshalled.

This course is measured to the guidelines defined by governing bodies Athletics Canada, AIMS and World Athletics.

Course Measurers: Marcel LaMontagne 403.874.1185, Jon Bird 403.618.2473
 Course Measured: April 21, 2024

Km Point	Waymarks Lat°/Lon°	Location Description
Start Line	51.035227 114.056723	Stampede Tr, south side of crosswalk to Big 4 bldg. 7.360m from street light to the south, east side, NBD
1 km	51.043395 114.053211	Olympic Way, 12m south of tunnel NBD
2 km	51.043008 114.040310	9 Ave NE, b/t white & blue bldg, 40m east Fair's Fair. EBD
3 km	51.045366 114.034001	Zoo Rd, 280m west of 12 Street bridge. WBD
4 km	51.048196 114.029013	St George's Dr NE, 55m east of diagonal pathway to St George's Dr. E/NBD
5 km	51.056202 114.026199	St George's Dr NE, * bike XW, 22m north. NBD
turn point 2024 5,006m	51.055616 114.026586	St George's Dr NE, * bike XW, 24m north. NBD
6 km	51.048380 114.029240	St George's Dr NE, 30m east, crossing bike path. SBD
7 km	51.052384 114.039585	Centre Av NE * 9A Street, 50m east. WBD
8 km	51.052633 114.051689	4 Street NE * Marsh Rd, 40m interchange. SBD
9 km	51.053581 114.062568	Centre Street Bridge, north end entrance. SBD
10 km	51.048985 114.051770	Riverfront Av SE * 5 Av o/p under o/p. EBD
11 km	51.044236 114.053125	9 Av * 4 Street/Olympic Wy, 50m, interchange WBD
12 km	51.042451 114.064392	11 Av SW * 1 Street SW, 80m east. WBD
13 km	51.042847 114.078645	11 Av * 7 Street, 20m east. WBD
14 km	51.043250 114.092899	11 Av * 13 Street, 50m east. WBD
15 km	51.051284 114.094619	14 Street at Kensington Close, intersection. NBD
16 km	51.048589 114.081766	Memorial Dr * LRT o/p, 50m east. EBD
17 km	51.057537 114.071343	Memorial DR NW, in line with 4A Street NW. EBD
18 km	51.052018 114.062366	Centre Street Bridge, south entrance. SBD
19 km	51.047783 114.050383	Confluence Way * 5 Street SE, intersection. EBD
20 km	51.042571 114.053286	Olympic Way * Tunnels entrance south end, 100m south, 3rd light post. SBD
21 km	51.039871 114.045839	Enmax Park Rd, mid point, at concrete bike. SBD
Finish	51.039396 114.046406	Enmax Park Rd, 17m from AC unit on post to SE, 18.5m from AC unit on post to NE at marked traffic parking line.