



# ATHLETICS CANADA

## ROAD RACE MEASUREMENT CERTIFICATE

### Race Information

Name of the course \_\_\_\_\_  
Certificate number \_\_\_\_\_ Distance \_\_\_\_\_ Race date \_\_\_\_\_  
City \_\_\_\_\_ Province \_\_\_\_\_  
Race contact name \_\_\_\_\_ Race contact email \_\_\_\_\_

### Course Information

Start elevation \_\_\_\_\_ Finish elevation \_\_\_\_\_  
Elevation change \_\_\_\_\_ Percent separation \_\_\_\_\_

### Measurer Information

Measurer name \_\_\_\_\_  
Measurement date \_\_\_\_\_ Expiry date \_\_\_\_\_

### Official Notice

Based on examination of data provided by the above named measurer, the course described above and in the map attached is hereby certified as reasonably accurate in measurement according to the standards adopted by the **Road Running Technical Council**. If any changes are made to the course, this certification becomes void, and the course must then be recertified.

### Validation of Course

In the event a **National Open Record** is set on this course, or at the discretion of **Athletics Canada**, a validation remeasurement may be required to be performed by a qualified measurer. If such a remeasurement shows the course to be short, then all pending records will be rejected and the course certification will be cancelled.

### As Nationally Certified by

Paul T.B. Adams

Signature of certifier

Date

Any inquires regarding this certificate should be directed to [coursemeasurement@athletics.ca](mailto:coursemeasurement@athletics.ca)



# Edmonton Marathon 2024

Marathon starts at Jasper Ave 96 Street proceeds East on Jasper Ave, North on 82 Street, East on 112 Ave, South 80 Street, East on 112 S Ave, South on 76 Street, East 110 Ave, South 75 Street, East on Ada Blvd, East on 111 Ave, South on 40 Street, West on 109 Ave, East on Ada Blvd, East on 104 Ave, North on 30<sup>th</sup> Street, West on 111 Ave, South on 32 Street, Turnaround is on 107 ave and 32 Street and return to Start/Finish line. West on Jasper Ave, North on 124 Street West on 102 Ave, South on St. George Crescent, South on 142 Street, East on Summit Dr, South on Riverside Drive, West on 95 Ave, South on 142 Street, East on Valleyview Drive, West on 91 Ave, South on 140 Street, East on 139 Street, East on 90 Ave, South on Valleyview, South on 137 Street, West on 87 Ave, Turn around at Buena Vista Road and 140 Street, Return to Start/Finish Area.

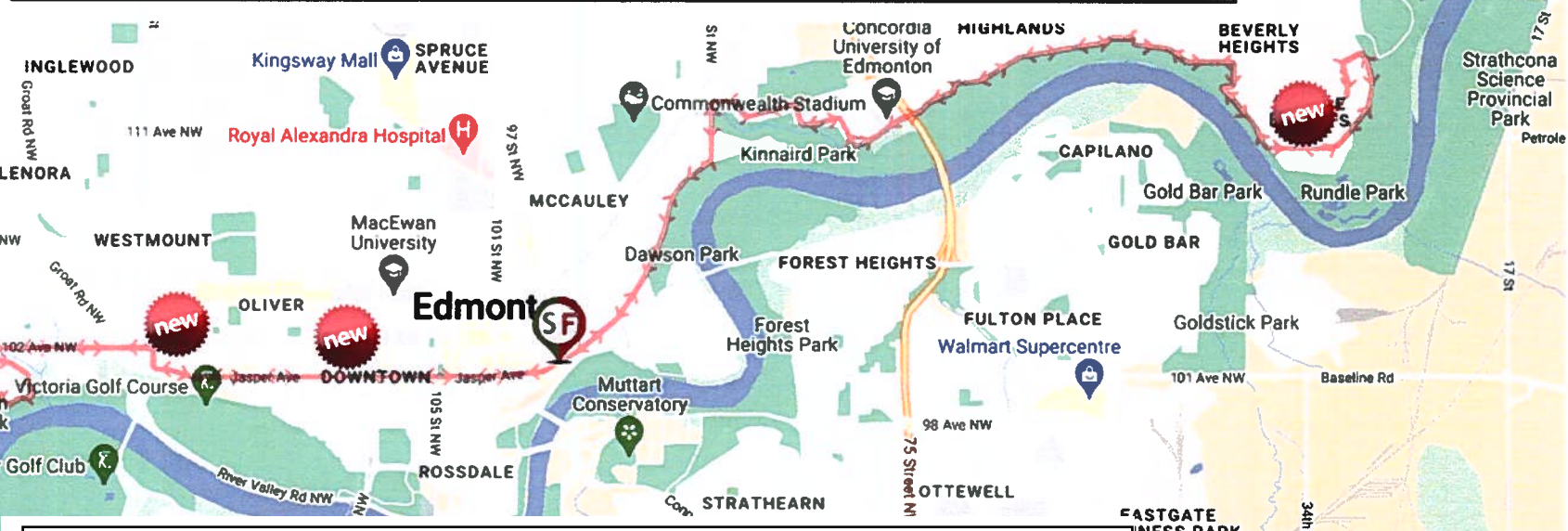

Runners are restricted to the 2 lanes on the south/southeast side of Jasper Avenue from the start/finish area to 112 Ave NW on the east side and to 102 Ave NW on the west side.

The marathon follows two half marathon routes first to the east and then to the west  
 See map pages 2-3 for details of the start, finish and turnarounds  
 See map pages 4-5 for east half marathon route  
 See map pages 6-7 for the west half marathon route

Measured by Darren Zimmerman  
 zimmerman1716@gmail.com



# START FINISHLINE DETAILS FOR EDM MARATHON 2024

EDMONTON MARATHON 2024	STARTLINE EB JASPER AVE
	FINISHLINE WB JASPER AVE

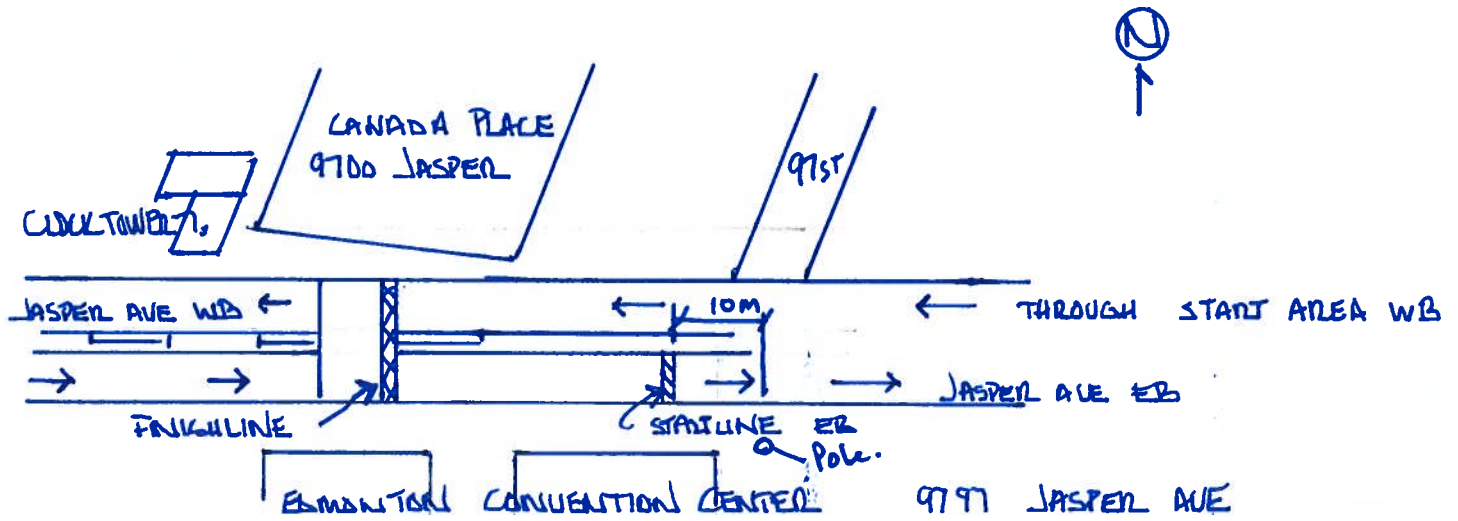



EDMONTON MARATHON 2024 TURN AROUND DETAILS

EASTSIDE HALF MARATHON TURN AROUND



\* NOT TO SCALE

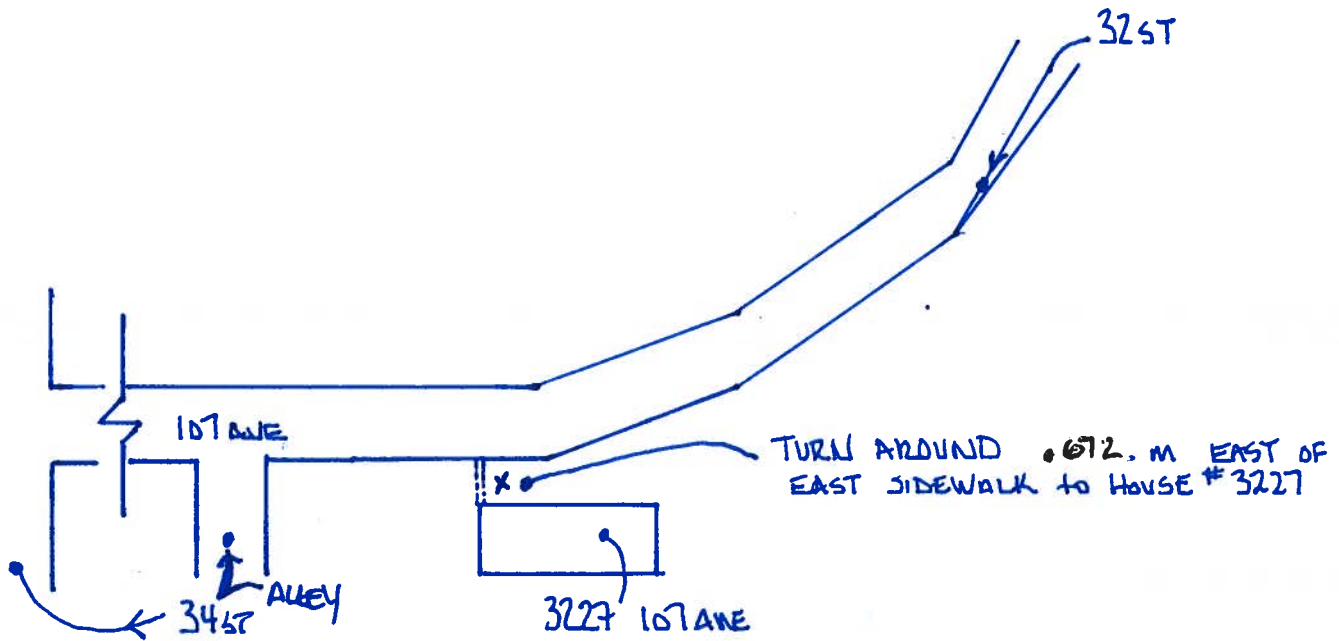

WESTSIDE HALF MARATHON TURN AROUND



\* NOT TO SCALE

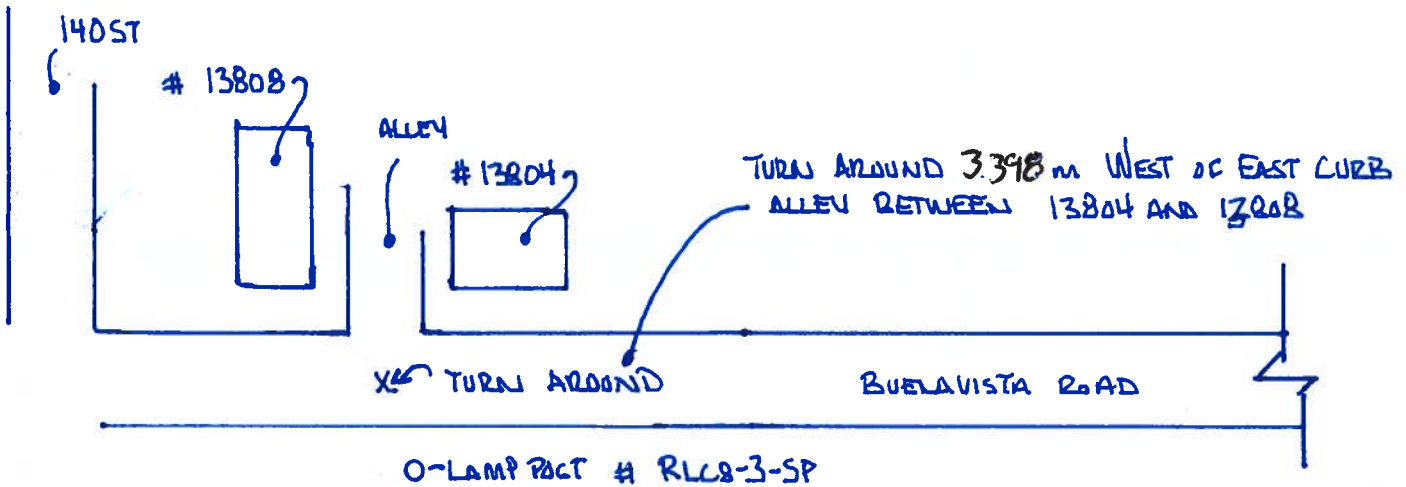

# Edmonton East Half Marathon 2024

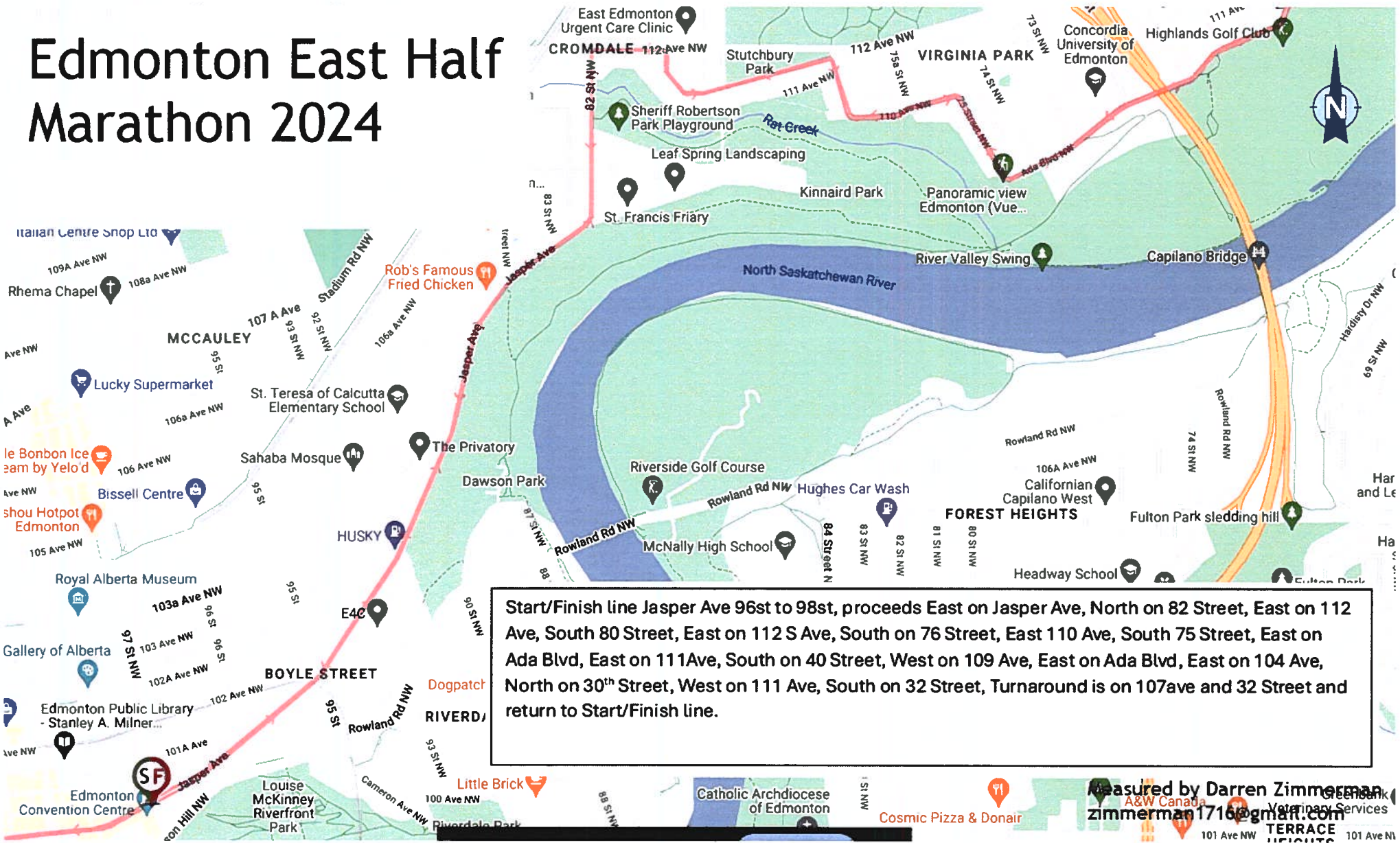

**Start/Finish line Jasper Ave 96st to 98st, proceeds East on Jasper Ave, North on 82 Street, East on 112 Ave, South 80 Street, East on 112 S Ave, South on 76 Street, East 110 Ave, South 75 Street, East on Ada Blvd, East on 104 Ave, North on 30<sup>th</sup> Street, West on 111 Ave, South on 32 Street, Turnaround is on 107ave and 32 Street and return to Start/Finish line.**

**Runners are restricted to 2 traffic lanes on the south/southeast side of Jasper Avenue from the start to 112 Ave NW**  
**See map page 2 for the east section of the course**

Measured by Darren Zimmerman  
 zimmerman1716@gmail.com  
 TERRACE HEIGHTS

# Edmonton East Half Marathon 2024

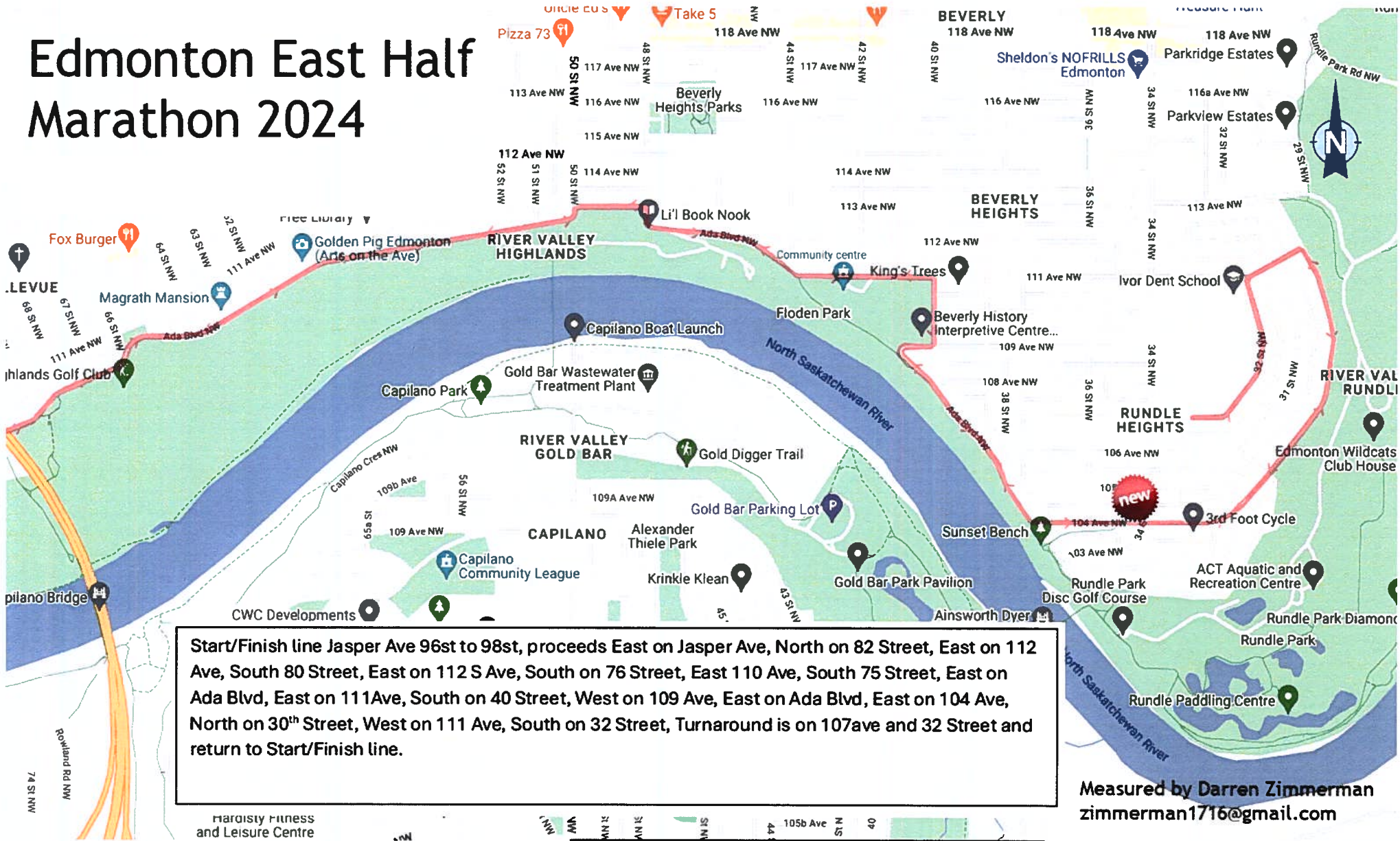

# Edmonton West Half Marathon 2024

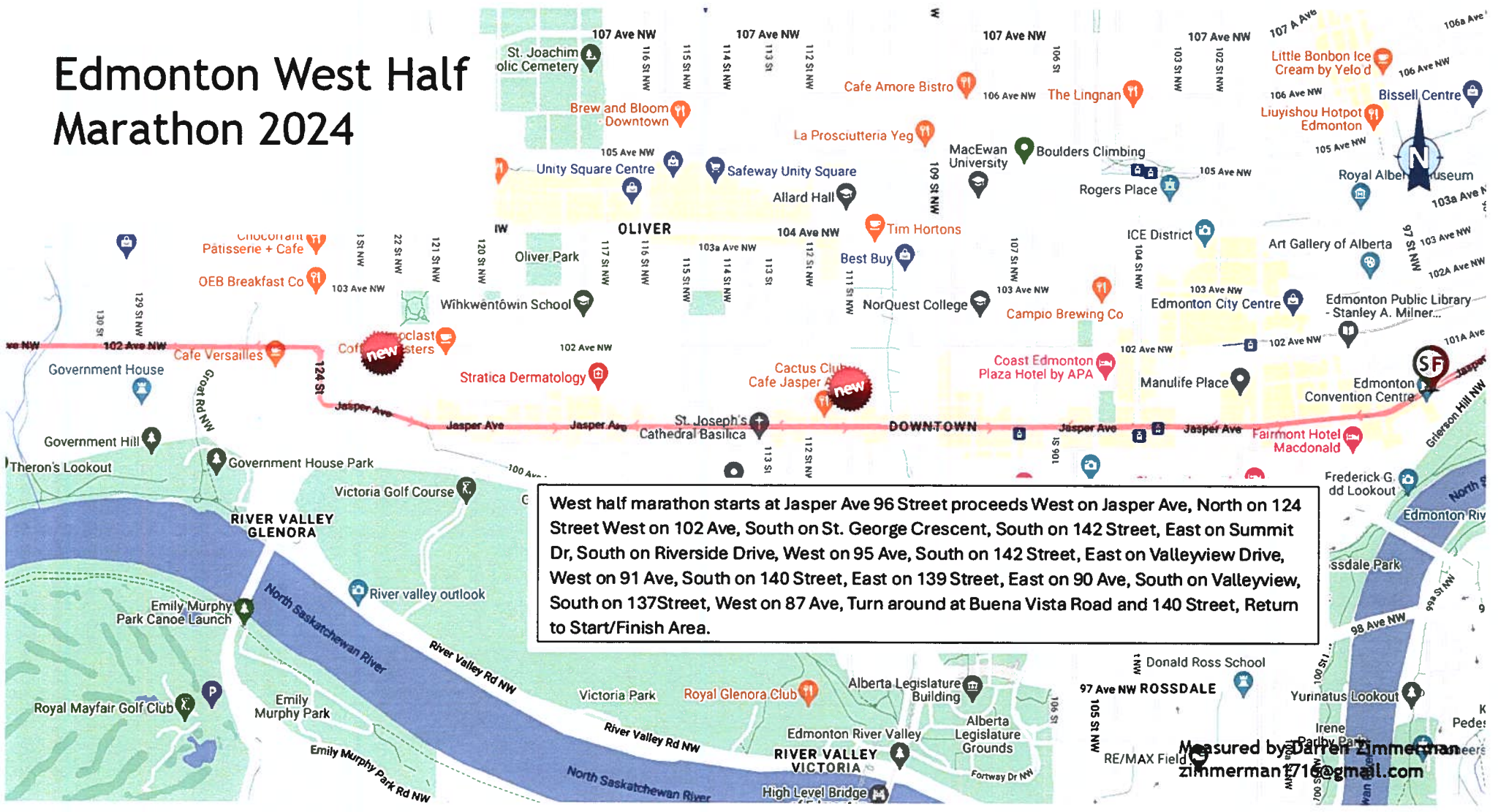

West half marathon starts at Jasper Ave 96 Street proceeds West on Jasper Ave, North on 124 Street West on 102 Ave, South on St. George Crescent, South on 142 Street, East on Summit Dr, South on Riverside Drive, West on 95 Ave, South on 142 Street, East on Valleyview Drive, West on 91 Ave, South on 140 Street, East on 139 Street, East on 90 Ave, South on Valleyview, South on 137 Street, West on 87 Ave, Turn around at Buena Vista Road and 140 Street, Return to Start/Finish Area.

Measured by Darren Zimmerman  
 zimmerman71@gmail.com

Runners are restricted to the 2 lanes on the south side of Jasper Avenue from the start to 102 Avenue NW  
 See map page 3 for details of the start/finish and turnaround



# Edmonton West Half Marathon 2024

West half marathon starts at Jasper Ave 96 Street proceeds West on Jasper Ave, North on 124 Street West on 102 Ave, South on St. George Crescent, South on 142 Street, East on Summit Dr, South on Riverside Drive, West on 95 Ave, South on 142 Street, East on Valleyview Drive, West on 91 Ave, South on 140 Street, East on 139 Street, East on 90 Ave, South on Valleyview, South on 137 Street, West on 87 Ave, Turn around at Buena Vista Road and 140 Street, Return to Start/Finish Area.

